



AFFINITY



WHITNEY LAKE CRAFTSMAN

Classic Southern charm with a balanced, livable design

Rooted in classic Southern character, the Whitney Lake pairs familiar architectural appeal with a well-balanced layout designed for everyday functionality. Its welcoming front porch sets the tone, offering a relaxed place to sit and enjoy the surroundings.

Inside, the kitchen connects seamlessly to the dining and living areas, creating a layout that feels open without losing definition. The primary suite includes a walk-in closet and is thoughtfully positioned for privacy, while two additional bedrooms offer comfortable space for family or flexible guest rooms. The overall design feels approachable, efficient, and well suited for both full-time living and time away.

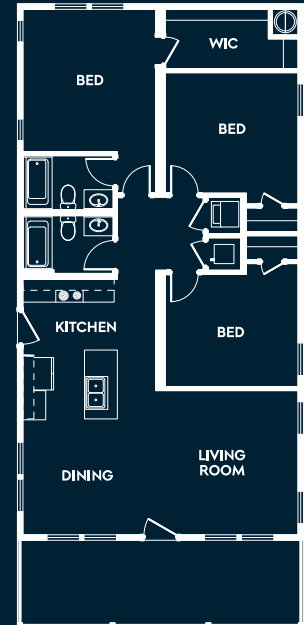

AT A *Glance*

1,280	SQUARE FEET
3	BEDROOMS
2	BATHROOMS
-	GARAGE
1	STORIES



For more information on this or any of our high-quality modular homes, learn more at affinitymodular.com

*Rendering shown for graphic purposes, actual elevations may vary.
All plans, pricing, items and features subject to change without notice.



WHITNEY LAKE CRAFTSMAN

1280 Sq. Ft Heated/Cooled
1489 Sq. Ft Under Roof

