

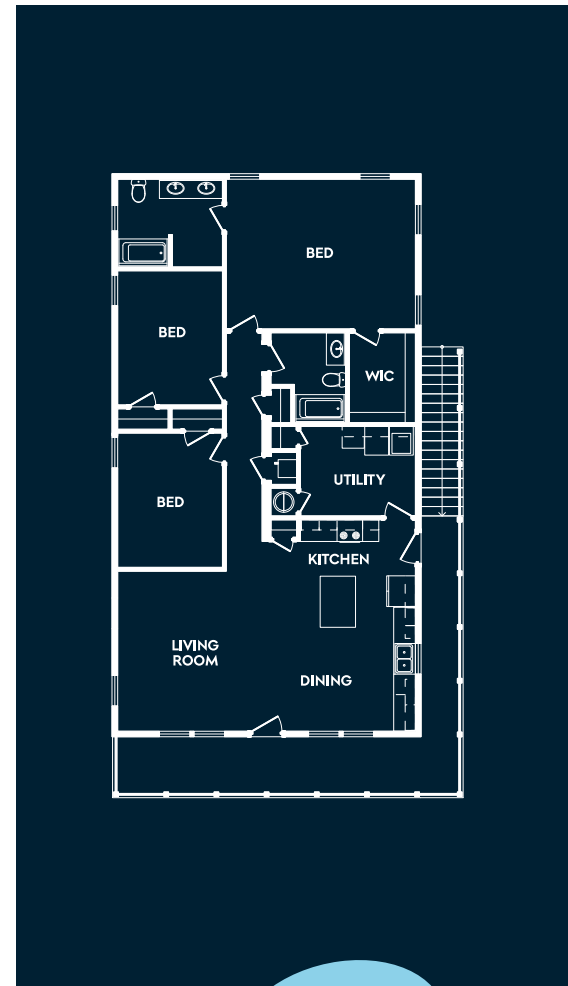

AFFINITY



ACADIAN

Classic style designed for easy living

The Acadian pairs inviting architecture with a layout designed for connection and everyday ease. At the heart of the home, the open kitchen, dining, and living areas create a welcoming central space that feels spacious yet comfortable, making it ideal for both daily routines and casual entertaining. Its design also allows for generous outdoor living additions tailored to the homesite and builder vision.

The private primary suite offers a spacious retreat with a walk-in closet and a thoughtfully designed bath, while two additional bedrooms provide flexibility for guests, family, or a home office. A dedicated utility room, generous storage, and optional elevator access add convenience, creating a home that blends classic style with lasting practicality.

AT A *Glance*

- 1,650 SQUARE FEET
- 3 BEDROOMS
- 2 BATHROOMS
- GARAGE
- 1 STORIES



For more information on this or any of our high-quality modular homes, learn more at affinitymodular.com

*Rendering shown for graphic purposes, actual elevations may vary.
All plans, pricing, items and features subject to change without notice.



ACADIAN

1650 Sq. Ft Heated/Cooled
1650 Sq. Ft Under Roof

