

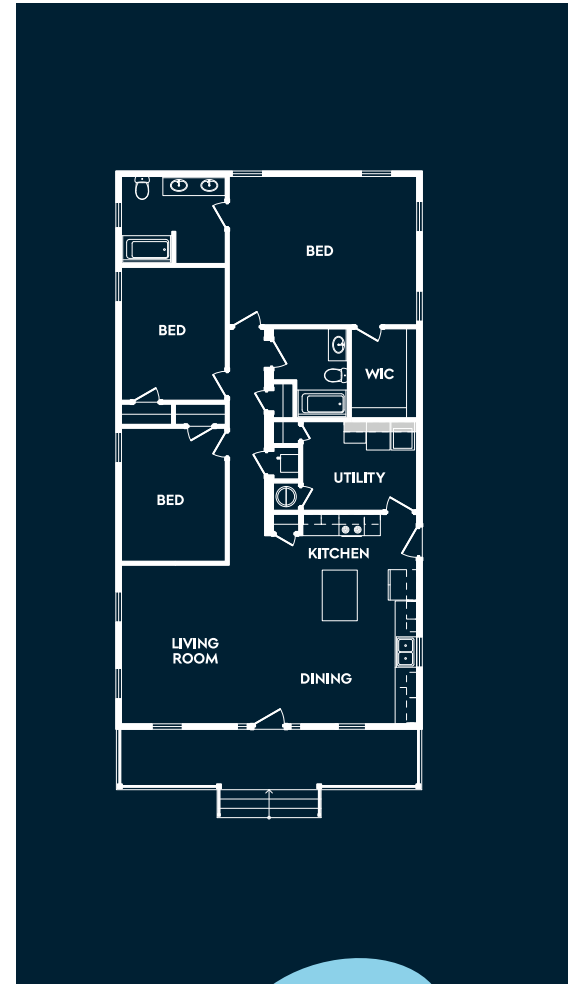

AFFINITY



ACADIAN CRAFTSMAN

Timeless craftsmanship with elevated comfort

Defined by classic Craftsman character and a welcoming covered front porch, the Acadian Craftsman is designed to feel at home in established neighborhoods or as a standout on a private homesite. Its proportions and layout reflect a more traditional approach to single story living, with open spaces that still maintain a sense of structure and comfort.

The living and dining areas are open yet well defined, with a kitchen that supports both everyday use and entertaining, especially with the option to add a side entry garage or carport for direct access into the utility room. That utility space is designed with function in mind, offering a storage closet and room for additional features such as a freezer or utility sink. The primary suite provides a spacious retreat with a walk-in closet, while secondary bedrooms are generously sized and supported by a centrally located hall bath, creating a home that feels practical, comfortable, and well suited for long-term living.

AT A *Glance*

- 1,650 SQUARE FEET
- 3 BEDROOMS
- 2 BATHROOMS
- GARAGE
- 1 STORIES



For more information on this or any of our high-quality modular homes, learn more at affinitymodular.com

*Rendering shown for graphic purposes, actual elevations may vary.
All plans, pricing, items and features subject to change without notice.



ACADIAN CRAFTSMAN

1650 Sq. Ft Heated/Cooled
1650 Sq. Ft Under Roof

